



On-Line Drippers

Non-Pressure Compensating Drippers For Vine, Tree and Greenhouse & Nursery

ON-LINE DRIPPER

Flow Rate vs. Pressure

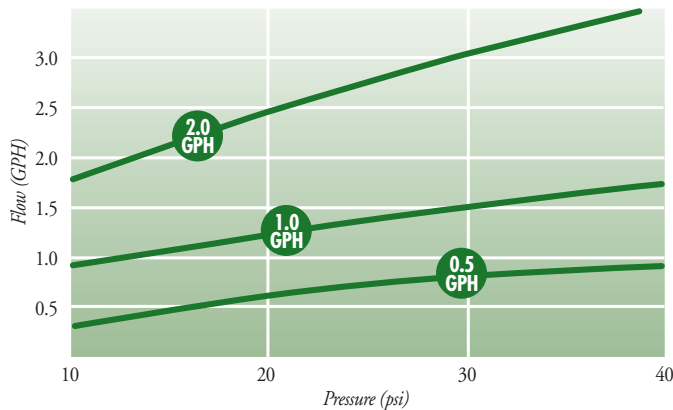

Turbonet Technology

Industry's Widest Flow Path

Wider cross-section allows large particles through dripper's short flow path.



TURBONET

Increased Turbulence in Flowpath

- Commonly used turbulent drippers have overlapping tooth patterns, easily catching debris. **Turbonet technology** improves dripper performance by widening the tooth pattern, maximizing flow path velocity, allowing particles to pass easily through the dripper, virtually eliminating plugging.

Product Advantages

Available in a variety of styles and flow rates. Perfect in many situations, offering complete adaptability to your needs.

- Manufactured from polypropylene and are extremely resistant to the strongest chemicals, even after many seasons of fertigation.
- Cv values less than 0.03.



Button Dripper

Designed with a barbed base for installation into blank polyethylene tubing using 3mm punch or pre-installed at Netafim USA.



Woodpecker Dripper

Designed for installation into polyethylene tubing. An additional barbed outlet accepts spaghetti tubing — 5/32mm or 1/8" tubing. Ideal for use in vineyards.

Applications

- Vine, tree, greenhouse and nursery.

Specifications

Color: Red (0.5 GPH),
Black (1.0 GPH)
Green (2.0 GPH)



NETAFIM USA

5470 E. Home Ave. • Fresno, CA 93727
888.638.2346 • 559.453.6800
FAX 800.695.4753
www.netafimusa.com

Non-Pressure Compensating Drippers Specifications

BUTTON AND WOODPECKER ON-LINE DRIPPER FLOW PATH DIMENSIONS

Dripper Flow	BD Part #	WP Part #	Length	Depth	Width
0.5 GPH	01BD2	01WP2	1.96"	.028"	.038"
1.0 GPH	01BD4	01WP4	1.96"	.047"	.050"
2.0 GPH	01BD8	01WP8	1.96"	.055"	.065"

BUTTON AND WOODPECKER ON-LINE DRIPPER DATA

Dripper Flow	Constant (K)	Exponent (X)	Cv (%)
0.5 GPH	0.146	0.48	2.5
1.0 GPH	0.294	0.48	2.5
2.0 GPH	0.557	0.50	2.5

BUTTON (BD) NON-PRESSURE COMPENSATING DRIPPERS PACKAGING DATA

Dripper Flow	Color Code	Qty. per Case	Weight (lbs.)	Part Number	Qty. per Bag	Weight (lbs.)	Part Number
0.5 GPH	Red	10,000	33.6	01BD2	250	4.2	01BD2-B
1.0 GPH	Black	10,000	33.6	01BD4	250	4.2	01BD4-B
2.0 GPH	Green	10,000	33.6	01BD8	250	4.2	01BD8-B

WOODPECKER (WP) NON-PRESSURE COMPENSATING BUTTON DRIPPERS PACKAGING DATA

Dripper Flow	Color Code	Qty. per Case	Weight (lbs.)	Part Number	Qty. per Bag	Weight (lbs.)	Part Number
0.5 GPH	Red	9,500	28	01WP2	250	1	01WP2-B
1.0 GPH	Black	9,500	28	01WP4	250	1	01WP4-B
2.0 GPH	Green	9,500	28	01WP8	250	1	01WP8-B

Non-Pressure Compensating Accessories

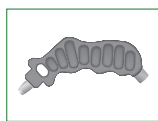

Plastic Hole Punch
for installing drippers in
PE Tubing - 0.125", 3mm

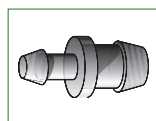

Dual Goof Plug
3mm/17mm



Vineline
Fits 0.670" (17mm) or 0.780" (18mm)
Fits 0.790" (20mm) Tubing

ACCESSORIES PART NUMBERS

682901033	Plastic Hole Punch
1107737-B	Dual Goof Plug
H670780R	.670" Vineline (17mm) or .780" (18mm)
H790R	.790" Vineline (20mm)

Netafim USA - Delivering Total Growing Solutions

- Dripelines • Filters • Valves • Air Vents • Sprinklers • Automation • Flow Meters
- For Agriculture, Landscape, Greenhouse & Nursery



For more information call Netafim USA
Customer Service at (888) 638-2346.