



QF Dripline Header

A Quick and Flexible Solution to Dripline Headers



Applications

The QF Dripline Header is an innovative product developed by the Rain Bird Landscape Drip Division to be a replacement for site-built headers in dripline installations. Its performance characteristics match PVC in terms of flow and pressure ratings. This Quick and Flexible product was specifically designed to eliminate the high labor costs and hassle associated with site-built headers. The flexibility and durability of the QF Header makes it ideal for curved or non-linear landscapes, making installation quick and easy.

Features

Performance

The QF Header has comparable design characteristics to a PVC header using the 5ft per second rule. It has similar volume and pressure performance to ensure proper flow to the dripline grid or other drip irrigation systems.

Operating Range:

- Pressure: 0 to 50 psi (0,0 to 4,14 bar)
- Temperature:
 - Water: Up to 100° F (37,8° C)
 - Ambient: Up to 125° F (51,7° C)

Flexibility

Patent-pending QF Header is the ONLY coiled header on the market. Made of a proprietary, dual-layered polyethylene blend for optimal flexibility. This product is ideal for curved or non-symmetrical landscapes and makes installation quick and easy. Simply roll out, connect to a water source and attach the dripline; it's that simple.

360° Pre-Installed XF Series Rotating Barbs

No other product has pre-installed barbs that ensure guaranteed spacing. The 360° rotating barbs allow for trenching misalignment – no need to re-trench, simply rotate the barb slightly to accommodate the dripline.

Utilizes the XF Series Fitting barb design, which requires 50% less force to insert – resulting in less hand and wrist fatigue.

A protective ring surrounds the barb, protecting it from damage and ensuring a proper seal. The ring also provides leverage when holding the barb and attaching the dripline.

Models

XQF7512100: XQF 25mm Dripline Header
30cms Spacings x 30mts
45cms Spacings x 30mts

360° Barbs

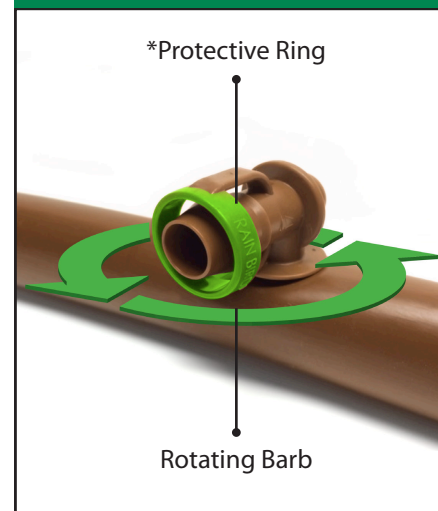

*Ring is colored here for illustrative purposes only

Specifications

The flexible, pre-manufactured header shall be made of polyethylene tubing and shall have factory installed barbs for use with any 16-17mm drip irrigation tubing. The barbs shall be spaced evenly per listed spacing (either 12 inch or 18 inch spacing). The polyethylene tubing shall be 25mm and work with industry standard fittings for polyethylene tubing, including: lock-style fitting, compression fittings, or insert style fittings (with clamp). The pre-manufactured header should be supplied in 30mts long coils. The flexible tubing allows for easy non-linear installations and shall conform to a 300mm radius without kinking. The QF Dripline Header inline tubing shall be manufactured by Rain Bird Corporation, Azusa, California.

Fittings Guide

The QF Dripline Header is designed to work with 25mm compression fittings, lock fittings and insert fittings with clamps.



Compression



Lock Fittings

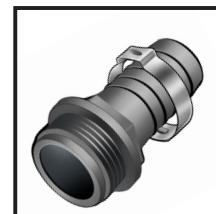

Insert Fittings
w/Clamps

XQF 25mm Dripline

Header Models:

- XQF-25mm -30cm x 30mts
- XQF-25mm - 45cm x 30mts

Relevant Dimensions:

Outer Diameter: 23.9mm
Inside Diameter: 20.8mm
Wall Thickness: 1.5mm

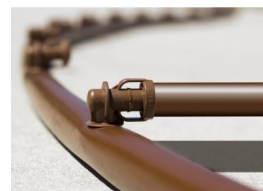

QF Dripline Header™

THE INDUSTRY'S FIRST PRE-FABRICATED HEADER / EXHAUST
QUICK. FLEXIBLE. EASY. NOW THAT'S INTELLIGENT.



**Rain Bird's Professional
Customer Satisfaction Policy**

**Rain Bird QF Dripline Header offers five (5) years on product
workmanship and seven (7) years on environmental stress cracking**

Rain Bird Corporation
6991 E. Southpoint Road
Tucson, AZ 85756
Phone: (520) 741-6100
Fax: (520) 741-6522

Rain Bird Technical Services
(800) RAINBIRD (1-800-724-6247)
(U.S. and Canada)

Rain Bird Corporation
970 West Sierra Madre Avenue
Azusa, CA 91702
Phone: (626) 812-3400
Fax: (626) 812-3411

Specification Hotline
800-458-3005 (U.S. and Canada)

Rain Bird International, Inc.
1000 West Sierra Madre Ave.
Azusa, CA 91702
Phone: (626) 963-9311
Fax: (626) 852-7343

The Intelligent Use of Water™

www.rainbird.com